

Subject

The following instructions provide a step-by-step procedure on how to repair a broken nipple on the urea pump

Tools Required

Pliers if rod becomes stuck (Optional)

Materials Included

Sand paper	x 1
Glue (Black)	x 1
Nipple	x 1
Alignment Rod	x 1
Gloves	x 1
Cotton Swabs	x 3



Step 1

Sand the damaged area of the nipple until it is flush with the base. Improper sanding will lead to pump leakage.

Please make sure to remove dust and debris after sanding.



Step 2

Feed the aligning rod into the nipple.

Stop when the rod is about an inch (2.54 cm) above the nipple's base.



Step 3

Apply the supplied adhesive on the inside of the nipple with 2-3 swabfulls.

Stay away from the center of the nipple.

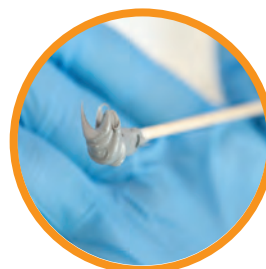

Grey color used for demonstration only

Approximately one swabfull



Step 4

Firmly fit the nipple on the pump. Push aligning rod all the way in, this will prevent any of the adhesive from clogging the urea passage port.

Do not use excessive force as this may puncture the filter and cause leakage.



Make sure your nipple is correctly fitted. Hand pressure only.



Incorrect fit



Correct fit

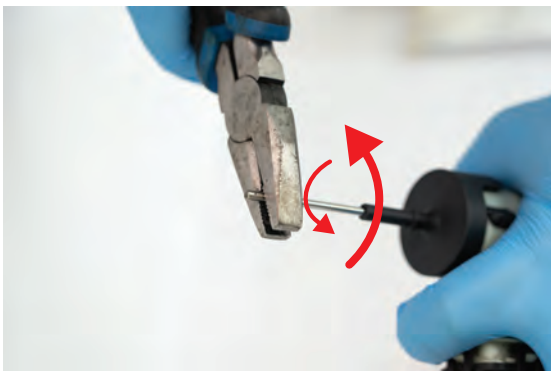

Step 5

After 6 hours (minimum), remove the rod and let the adhesive cure for 24 hours prior to use.

Make sure to gently rotate the Rod out of the nipple



Step 6

You're all done!